



## VIKING WINDOW TILT AND SLIDE PATIO DOORS

Viking Window AS is an Estonian company which started the production of wood windows and exterior doors in 1997. Today the company has become one of the leading manufacturers of wood and aluminum clad windows and doors. Its products are highly valued on the international market. In addition to the United Kingdom and Ireland, Viking Window products are sold to Sweden, Norway, Denmark, Iceland, France and Japan. Viking Window is renowned for the high quality of the products, customer service and short lead times. All products are made to measure from environmentally friendly materials sourced sustainably.



Since 2000 Viking Window AS quality management system complies with the ISO 9001 standard. Since 2005 company's environmental management system complies with the ISO 14001 standard.

Since 2000 Viking Window AS quality management system complies with the ISO 9001 standard. Since 2005 company's environmental management system complies with the ISO 14001 standard.



The mark of responsible forestry

Since 2007, we have the FSC Chain of Custody certificate which proves that we use timber from responsibly managed forests.



In 2009 compliance to Norwegian Door and Window standards was certified.

### Tilt and Slide Patio Door

It is best for balconies, terraces and other places where there is not enough room for traditional outward or inward opening door or where is a need for large glazed areas. The Tilt and slide door is available both as wooden and aluminum-clad door. In addition to traditional sideways slide opening it tilts at the top for ventilation.

#### Advantages of the Tilt & Slide Patio Door:

- Practical tilt and slide functions combined in a single sash
- Excellent thermal performance with triple glazing  $U_w = 0,97 \text{ W/m}^2\text{K}$  or with double glazing  $U_w = 1,29 \text{ W/m}^2\text{K}$ ;
- Easy cleaning
- Durability and ease of use

The product is based on same profile system as Viking inward opening wooden window and therefore it does not have conventional threshold. GU hinges system enables to manufacture up to 130 kg opening sash. The sliding doors by Viking Window are made using high quality solid wood. Premium Nordic laminated pinewood is used to guarantee the long service life of the wooden parts.

Traditional double glazing ( $U_g = 1,1 \text{ W/m}^2\text{K}$ ) or energy efficient triple glazing ( $U_g = 0,6 \text{ W/m}^2\text{K}$ ) can be used. The insulating glass units can consist of various types of panes, depending on the user's requirements - reinforced/safety glass, energy-saving or acoustic glass, glass with sun protection properties.

Profiles and technical properties are similar to Viking DK13 windows. Finishing according RAL, NCS (paint) or Vikings (lacquer) tone catalog by customer's choice preference.

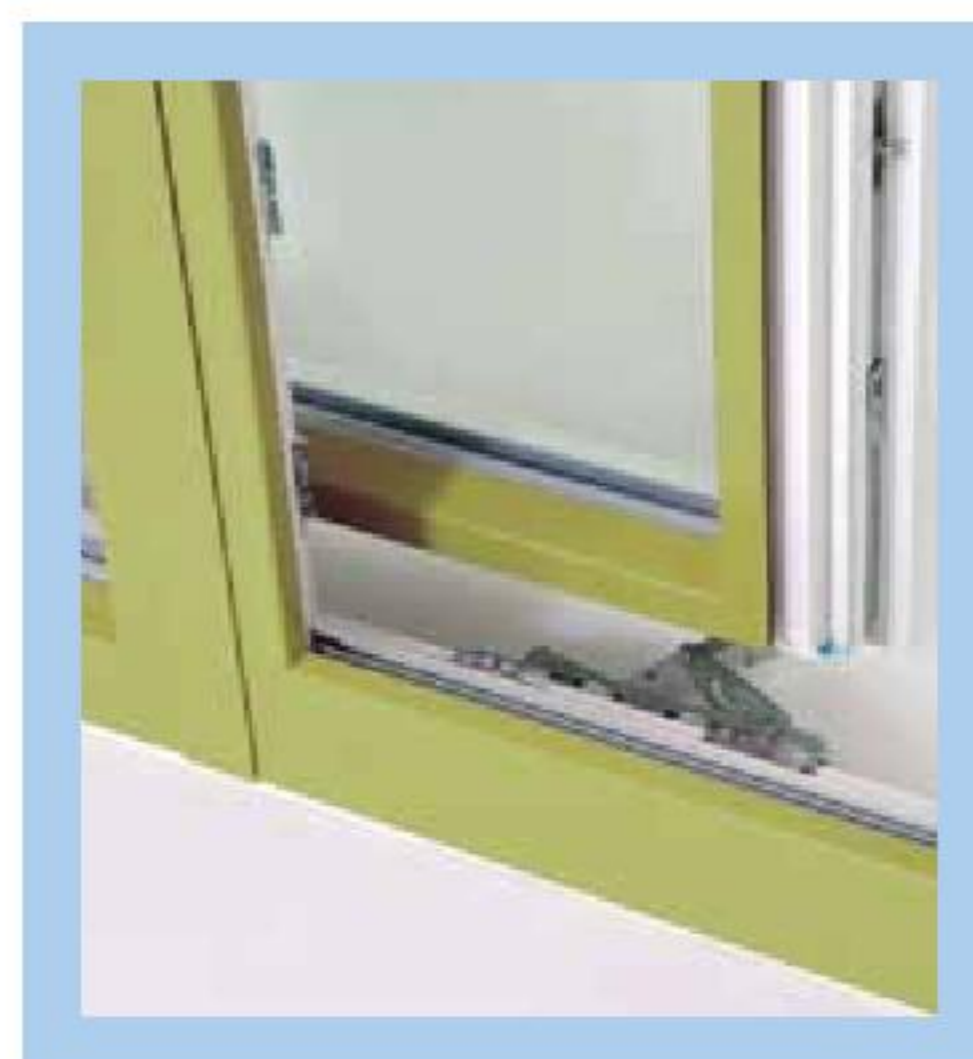

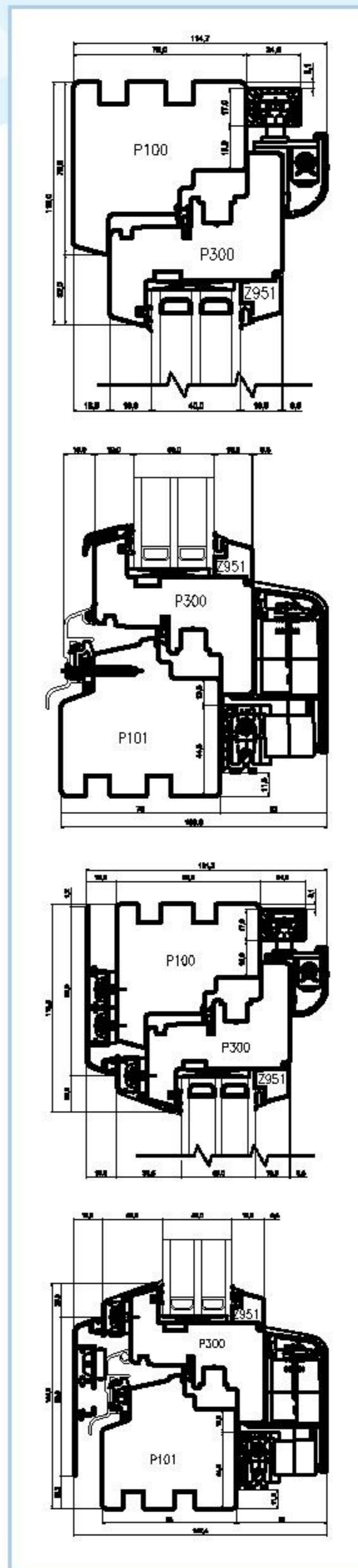

#### Technical properties of tilt and slide door:

- Thermal transmittance:  
With double glazing  $U_w = 1,29 \text{ W/m}^2\text{K}$ ;  
With triple glazing  $U_w = 0,97 \text{ W/m}^2\text{K}$ ;  
Thermal window  $U_w = 0,87 \text{ W/m}^2\text{K}$ ;
- Sound insulation:  
With double glazing  $R_w (C; C_{tr}) = 33\text{db} (-1; -4)$ ;  
With triple glazing  $R_w (C; C_{tr}) = 35\text{db} (-1; -5)$ ;
- Cross sections: frame  $78 \times 78 \text{ mm}$ ; sash  $78 \times 78 \text{ mm}$ ; transom/mullion  $105 \times 78 \text{ mm}$ ; glazing bar  $63 \times 78 \text{ mm}$  or  $85 \times 78 \text{ mm}$ ;
- Pine wood with quality class A1-A3;
- Wooden profiles treated with water based preservative;
- Glazing unit: double glazing  $26 \text{ mm}$  ( $U_g = 1,1 \text{ W/ W/m}^2\text{K}$ ) or triple glazing  $40 \text{ mm}$  ( $U_g = 0,6 \text{ W/ W/m}^2\text{K}$ );
- Hardware: GU Unijet;
- Frame dimensions:  $W \times H \text{ max. } 3,2 \times 2,5 \text{ m}$ ;
- Multilight windows with transoms and mullions;
- Weight of the opening sash up to  $130 \text{ kg}$ .



EN 14351-1:2006 + A1:2010

#### Warranty

All products come with a five year warranty.

[www.vikingwindow.eu](http://www.vikingwindow.eu)

HEAD OFFICE AND PRODUCTION  
Mäo 72751 Järva County Estonia  
Phone +372 384 8900  
Fax +372 385 3027  
e-mail: [viking@viking.ee](mailto:viking@viking.ee)  
[www.vikingwindow.eu](http://www.vikingwindow.eu)

PI Måleri & Kakel AB - Dörr & Fönstershopen.  
Mia Ivarsson 070-4958444  
e-mail: [info@pimaleri.se](mailto:info@pimaleri.se)  
[www.pimaleri.se](http://www.pimaleri.se)